

5CCT SELECTABLE SLIM DOWNLIGHT MANUAL

INSTALLATION & OPERATING INSTRUCTION GUIDE

READ THESE IMPORTANT SAFETY INSTRUCTIONS

Please read and understand this entire manual before attempting to assemble, operate or install this product.

1. **RISK OF FIRE OR ELECTRIC SHOCK:** The electrical rating of this product is 120V AC.
2. **Danger-Risk Of Shock-Disconnect Power Before Installation**
3. **WARNING** - To prevent wiring damage or abrasion, do not expose wiring to edges of sheet metal or other sharp objects.
4. Suitable For Damp Locations
5. This product must be installed in accordance with any applicable installation code(s) by a qualified electrician or person familiar with the construction and operation of the product and the hazards involved.
6. This Device Is Not Intended For Use With Emergency Exits

For your safety, please read and instructions completely before beginning the installation.

CAUTION: To avoid possible electrical shock, be sure that power supply is turned off at the fuse box/circuit breaker before installing or servicing the fixture.

PACKAGE CONTENTS

Make sure all parts are present before beginning installation of this product. Compare package contents with parts list and diagram shown here. If parts are missing or damaged, do not assemble, install or operate this product.

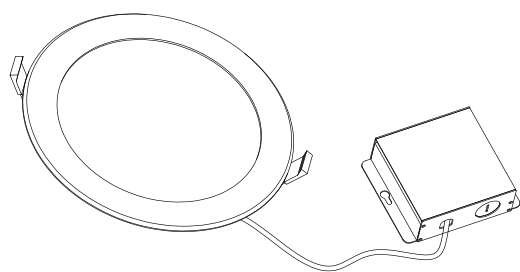

PRODUCT ELECTRIC RATING

PRODUCT	WATT	CURRENT	INPUT VOLTAGE
4" DOWNLIGHT	10W	120MA	120V 60HZ
6" DOWNLIGHT	12.5W	120MA	120V 60HZ

PRE-INSTALLATION:

1. Select color and move the CCT switch. you can change the color temperature to : 2700k/3000k/3500k/4000k/5000k by the CCT switch.
2. Turn power OFF from the electrical panel before starting installation.
3. Locate a suitable position to plate the fixture and open in accordance to the cut-hole dimensions (refer to Hole Cut Table for appropriate size).
4. Run electrical wire from the switch (power supply) through the mounting hole - use NMD90 Romex or BX cable.

DRIVER WIRING:

1. Open the hardwire box swing cover and remove the appropriate knockout(s).
2. Insert the electrical supply cable through the knockout and secure with a cable connector (sold separately).
3. Using wire nuts, connect green ground wire of cable to green wire on box. Connect white wire of cable to white wire of box. Connect black wire of cable to black wire of box. (Fig. 1)
4. Place all wiring and connections back in to the box and close the cover.
5. Insert hardwire box through the mounting hole. (Fig.2)
New construction applications: Hardwire box shall be firmly secured to studs, joists, or similar fixed structural units.
Remodel applications: Do not require the hardwire box to be firmly secured after the mounting plates, studs, joists, or structural units have been concealed.

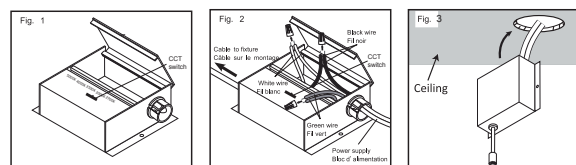

FIXTURE INSTALLATION:

1. Connect the fixture to the hardwire box by inserting and twisting the male/female connectors. (Fig. 3)
2. Push spring loaded clips on the fixture upwards and insert fixture base in to the mounting hole. Release the clips and fixture will be pulled flush to the ceiling. (Fig.4)
3. Once assembly is complete, turn on power to confirm fixture is working properly.

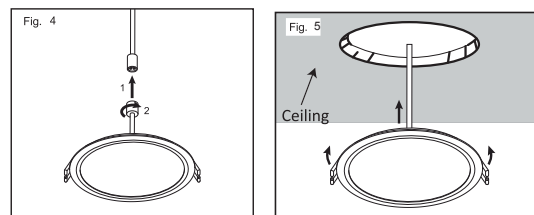

Hole Cut Size

FX-5CCT-DL4IN10W	Ø4-1/4" (108mm)
FX-5CCT-DL6IN12W	Ø6-1/4" (158mm)