

Installation Instructions

NLOPAC Series - Surface Mount AC Opal

READ PRIOR TO ATTEMPTING INSTALLATION
ALWAYS TURN OFF MAIN POWER BEFORE INSTALLATION
INSTALLATION SHOULD BE CARRIED OUT BY YOUR LOCAL ELECTRICIAN

⚠ WARNING - This equipment is intended to be installed only by qualified personnel. The installation must be made in accordance with the current edition to the National Electric Code and all applicable state and local building codes. The final installation must be approved by the appropriate qualified electrical/building inspector(s). Improper installation may result in a fire or electrical hazard. Be sure the electrical power to the circuit has been disconnected before installing this electrical system.

⚠ AVERTISSEMENT - Cet équipement est destiné à être installé uniquement par du personnel qualifié. L'installation doit être faite en conformité avec l'édition actuelle du Code national de l'électricité et toutes étatiques et locales codes du bâtiment applicables. L'installation finale doit être approuvée par l'inspecteur en électricité / bâtiment qualifié approprié(s). Une mauvaise installation peut entraîner un incendie ou un risque électrique. Soyez sûr de la puissance électrique vers le circuit a été coupée avant l'installation de ce système électrique.

1. Open the hood
2. As shown in the arrow position on the right, adjust the switch to select the color you want.
3. Close the cover

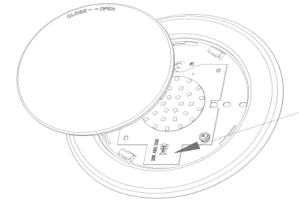

J-BOX INSTALLATION INSTRUCTIONS:

1. Tear off the label.
2. Rotate the lens to the left to remove it. Set lens aside.
3. Connect wires from J-box to wires from Nora AC Opal according to local and national electrical codes.
4. Attach fixture to the J-Box using key-hole slots with the screws provided.
5. Re-attach the lens by rotating it to the right.

NOTE: When installing the lens line up clips on lens away from clips in pan then twist.

⚠ IMPORTANT: Should mounting holes not line up with hole(s) in J-box, secure the Opal to the ceiling material using compatible screws making sure to completely cover j-box.



Fig. 1

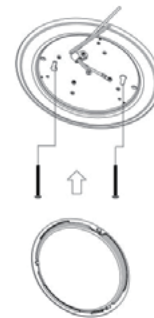

Fig.2(2.75" J-Box-Installation)

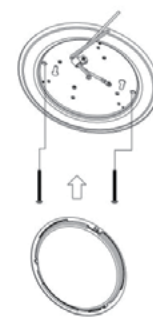

Fig.3(3.5" J-Box-Installation)

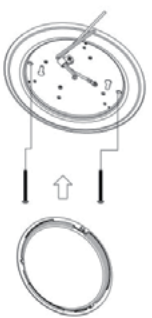

Fig.4(4" J-Box-Installation)

RECESSED HOUSING INSTALLATION KIT (SOLD SEPARATELY):

1. Please examine all parts that are not intended to be replaced by the retrofit kit for damage and replace any damaged parts prior to the installation of the retrofit kit.
2. Remove existing trim from recessed housing. Verify housing has holders that will accommodate the torsion springs from kit.
3. Tear off the label from the fixture.
4. Rotate lens to the left to remove it. Set Aside.
5. Affix the spring sets to the fixture using the screws provided. (See Figure 5)
6. Wire the AC Opal to the socket adapter.
7. Screw the socket adapter into existing socket in housing. (See Fig.6)
8. Squeeze both torsion spring arms together and insert into the torsion spring slots (or receiver brackets) of the recessed housing. (Fig.7)
9. Tuck all wires into the recessed housing and carefully push the push the Opal tight to the ceiling. (Fig.7)
10. Re-attach the lens by rotating it to the right. Ensure lens is securely fastened.

NOTE: When installing the lens line up clips on lens away from clips in pan then twist.

⚠ IMPORTANT: Should mounting holes not line up with hole(s) in J-box, secure the Opal to the ceiling material using compatible screws making sure to completely cover j-box.

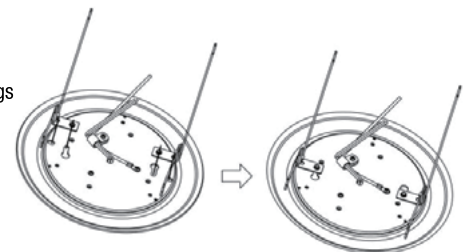
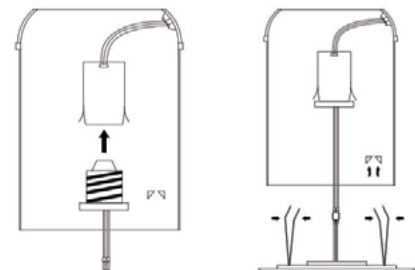

Fig.5



MIN. LAMP COMPARTMENT DIMENSIONS 152 (DIA) X 127(H) mm

Fig.6 (5"/6" Housing Installation) Fig.7 (5"/6" Housing Installation)